

其它玻璃纤维产品

FIBERGLASS PRODUCTS FOR
Other Processes





膨化工艺

无碱玻璃纤维膨体纱和膨体用纱

增强石膏工艺

增强石膏用无碱玻璃纤维湿法短切原丝

增强石膏用玻璃纤维无捻粗纱

汽车顶棚成型工艺

无碱玻璃纤维粉剂短切原丝毡

Texturizing Process

Texturized Rovings

Reinforcements for Gypsum

Wet Chopped Strand for Gypsum

Assembled Roving for Gypsum

Automotive Headliner Molding Process

Powder Chopped Strand Mat

膨化工艺

将粗纱引入膨化机中，在压缩空气气流作用下将粗纱打散膨化，然后再将膨化后的粗纱重新绕成纱团。

Texturizing Process

The roving is introduced to the texturizing machine (air jet), which breaks the surface fibers at random under the effect of compressed air. That gives the roving a bulkier appearance. Then, the texturized roving is wound into a bobbin.

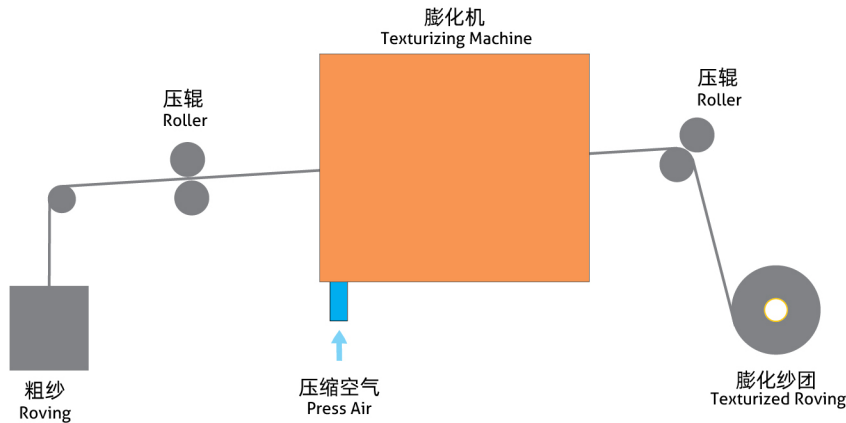

无碱玻璃纤维膨体纱

无碱玻璃纤维膨体纱具有膨化均匀、吸附能力强等特点，适用于增强酚醛树脂、环氧树脂和饱和聚酯树脂等。

Texturized Roving

Texturized Roving is compatible with PF, EP, UP and UP resins. It features uniform texturizing and high absorbability

产品牌号 Product Code	典型线密度(tex) Nominal Linear Density	适用树脂 Resin Compatibility	产品特点 Product Features	典型应用 Typical Applications
752A	2400, 3500, 4800	酚醛树脂, 环氧树脂, 不饱和聚酯树脂 UP, EP, PF	膨化效果好, 与树脂相容性好, 制品机械性能高 Optimum texturing efficiency, compatible with multiple resins, excellent mechanical properties of composite products	拉挤型材 Pultrusion profiles
752T	4800	\	膨化效果好, 毛羽少, 耐高温 Good texturizing, low fuzz, high temperature resistance	汽车消音器 Car muffler



无碱玻璃纤维膨体用纱

无碱玻璃纤维膨体用纱具有膨化均匀、吸附能力强等特点，适用于增强酚醛树脂、环氧树脂和阻燃不饱和聚酯树脂等。

Texturized Rovings

Texturized Rovings are compatible with PF, EP and UP resins. They feature texturizing uniformity and high absorbability.

产品牌号 Product Code	典型线密度(tex) Nominal Linear Density	适用树脂 Resin Compatibility	产品特点 Product Features	典型应用 Typical Applications
702	300, 400, 500, 600, 1000, 1200	\	湿纱, 纱质柔顺, 毛羽少, 使用工艺性能和膨化效果好 <i>Wet and soft strand, low fuzz, good processing and texturizing performance</i>	密封、绝热材料 <i>Sealing and thermal insulation materials</i>
752	660, 2400, 4600	酚醛树脂、环氧树脂、 不饱和聚酯树脂 <i>Phenolic resin- epoxy resin- unsaturated polyester resin</i>	膨化效果良好, 树脂吸附能力强, 与树脂相容性好, 制品机械强度高 <i>Good expansion effect, strong resin adsorption capacity, good compatibility with resin, high mechanical strength of products</i>	汽车摩擦片、消音器 <i>Automobile friction plate, muffler</i>

膨化工艺的终端应用市场

(建材 / 汽车)

End-Use Markets

(Building / Automotive)

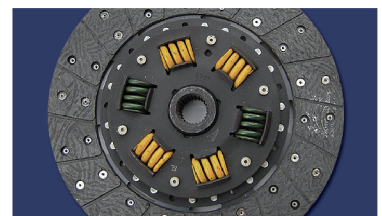

增强石膏工艺

将石膏粉和其他填料搅拌成水浆料，加入玻璃纤维并搅匀，浆料输送到传送带上成型，经烘干并切割成板材。

Reinforcements for Gypsum

The slurry is prepared by mixing gypsum powder with other fillers. Then fiberglass is added into the slurry. The slurry is laid on the conveyor for further drying and cutting to form the final sheet.



增强石膏用无碱玻璃纤维湿法短切原丝 Wet Chopped Strand for Gypsum

产品牌号 Product Code	纤维直径 (μm) Filament Diameter(μm)	短切长度 (mm) Chopped Length (mm)	适用树脂 Resin Compatibility	典型应用 Typical Applications
546	13, 16	3, 6, 12	分散性好, 制品强度高 <i>Excellent dispersion and good mechanical properties of composite products</i>	增强石膏 <i>Reinforced gypsum</i>



增强石膏用玻璃纤维无捻粗纱 Assembled Roving for Gypsum

产品牌号 Product Code	纤维直径 (μm) Filament Diameter(μm)	典型线密度(tex) Nominal Linear Density (tex)	产品特点 Product Features	典型应用 Typical Applications
512	15	2400	在浆料中彻底分散, 制品强度极高 <i>Excellent dispersion in slurry, very high mechanical properties</i>	特种防火板 <i>Fireproof panels</i>

增强石膏的终端应用市场 (建筑)

End-Use Markets (Building)

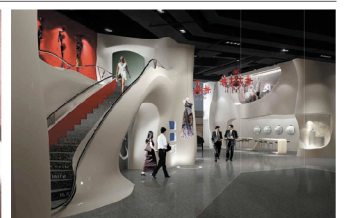
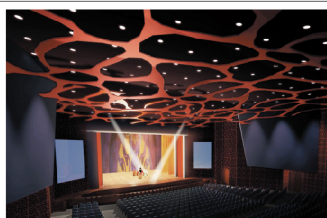
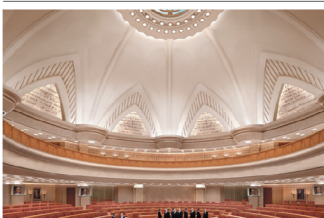

汽车顶棚成型工艺

采用PU发泡片材、玻璃纤维或玻璃纤维短切原丝毡、无纺涤纶布等材料通过粘结剂层压粘成型，制得汽车内饰顶棚。

Automotive Headliner Molding Process

PU foam sheets, fiberglass or fiberglass chopped strand mats and non-woven polyester fabrics are bound by a binder and laminated to form automotive headliners.



无碱玻璃纤维粉剂短切原丝毡

无碱玻璃纤维粉剂短切原丝毡是由玻璃纤维原丝经短切后，随机无定向均匀平铺，然后用粉剂粘结剂粘结在一起的片状毡片。

无碱玻璃纤维粉剂短切原丝毡P10主要用于生产汽车内饰顶棚，客户也可根据需要用于生产其他复合材料制品。

Powder Chopped Strand Mat

P10 Powder Chopped Strand Mat is made of randomly distributed chopped E6 glass strands held together by a powder binder.

P10 is designed for use in automotive headliners and can also be used in other composite products as per customers' requirements.

产品牌号 Product Code	单位面积克重 (g/m ²) Area Weight(g/m ²)	典型幅宽 (mm) Typical Width(mm)	产品特点 Product Features
P10	100, 110, 135	1040, 1270	低克重, 用于生产汽车顶棚 <i>Low weight, suitable for user in automotive headliners</i>

汽车顶棚成型工艺的终端应用市场

(汽车顶棚)

End-use Markets of Automotive Headliner Molding Process

(Automotive Headliners)



开模成型用玻璃纤维产品 Fiberglass Products for Open Molding	喷射成型工艺 Spray-up Process
	手糊成型工艺 Hand Lay-up Process
管道成型用玻璃纤维产品 Fiberglass Products for Pipes	缠绕成型工艺 Filament Winding Process
	离心浇铸成型工艺 Centrifugal Casting Process
模压成型用玻璃纤维产品 Fiberglass Products for Compression Molding	SMC成型工艺 SMC Process
	BMC成型工艺 BMC Process
	LFI工艺 LFI Process
连续型材用玻璃纤维产品 Fiberglass Products for Continuous Profiles	拉挤成型工艺 Pultrusion Process
	连续板材成型工艺 Continuous Panel Molding Process
热塑性塑料用玻璃纤维产品 Fiberglass Products for Thermoplastics	挤出与注塑工艺 Extrusion and Injection Processes
	LFT成型工艺 LFT Process
	GMT成型工艺 GMT Process
	CFRT成型工艺 CFRT Process
其它玻璃纤维产品 Fiberglass Products for Other Processes	膨化工艺 Texturizing Process
	增强石膏工艺 Reinforcements for Gypsum
	汽车顶棚成型工艺 Automotive Headliner Molding Process
布毡用玻璃纤维产品 Fiberglass Products for Fabrics and Mats	编织工艺 Weaving Process
	制毡工艺 Mat Production Process
玻璃纤维制品 Fiberglass Products for Fabrics and Mats	制毡工艺 Mat Production Process
	编织工艺 Weaving Process
高性能复合纤维 High Performance Hybrid Fibers	模压成型 Mold Pressing
	层压板材成型 Laminate Molding
	缠绕成型 Filament Winding
	拉挤成型 Pultrusion
	真空辅助成型 Vacuum-Assisted Molding
细纱产品 Glass Yarns	电子布编织工艺 Electronic Fabric Weaving Process
	工业布编织工艺 Industrial Fabric Weaving Process
电子布产品 Electronic Fabrics	覆铜板上胶工艺 Copper Clad Laminate Coating Process
	绝缘板上胶工艺 Insulation Board Coating Process



地址: 浙江省桐乡经济开发区, 邮编: 314500
 Add: Tongxiang Economic Development Zone, Zhejiang 314500, China

(国内销售 Domestic Sales) 电话Tel:+86-573-88181016 传真Fax:+86-573-88136248
 (国际销售 International Sales) 电话Tel:+86-573-88136318 传真Fax:+86-573-88181058
 (客服 Customer Service) 电话Tel:+86-573-88136325 传真Fax:+86-573-88136248

http://www.jushi.com E-mail: info@jushi.com

